

# MINI Center



- Training
- Tool room workshop
- Metal parts machining
- Model making
- R&D
- Cast iron is tempered for stress relief to ensure machine stability without deformation



Technical Specifications		Mini Center
<b>Table</b>		
Table size	mm	650 x 300
T-slot (width x number x distance)	mm	14 x 3 x 100
Max. load	kg	200
<b>Travel</b>		
X / Y / Z Travel	mm	500 / 300 / 400
Spindle nose to table	mm	120 - 520
Spindle center to column	mm	340
<b>Spindle</b>		
Spindle taper	-	SK 40 / BT 40 / CAT 40
Spindle motor power/torque	-	4.8/19kW; 27/65Nm (SIEMENS) 3.7/13kW; 23.6/82.8Nm (FANUC)
Spindle speed	rpm	10000
<b>Feed</b>		
Rapid speed	m/min	X/Y: 24, Z: 16
Cutting speed	mm/min	1-10000
<b>Tool changer</b>		
Number of tools	pcs	12
Max. tool length	mm	300
Max. tool diameter	mm	Φ90 / Φ125
Max. tool weight	kg	8
<b>Accuracy (VDI 3441 Full travel)</b>		
Positioning accuracy	mm	0.010
Positioning repeatability	mm	0.008
<b>Dimensions &amp; Weight</b>		
Dimensions	mm	1660x2000x2495
Weight	kg	1800

### Standard configuration

- ✓ Fully enclosed splash guard
- ✓ Belt drive spindle 10000 rpm
- ✓ 12 position umbrella tool changer
- ✓ Heat exchanger for electrical cabinet
- ✓ Rigid tapping
- ✓ Ethernet, CF card and USB interface
- ✓ Automatic lubrication system
- ✓ Coolant system
- ✓ LED working lamp
- ✓ End of program light
- ✓ Electronic handwheel (MPG)
- ✓ Tool box
- ✓ Leveling bolts and blocks
- ✓ Coolant gun
- ✓ Air gun
- ✓ Chip flushing system
- ✓ User Manual

### Optional configuration

- Spindle oil cooler
- Workpiece probe
- Tool probe
- 4<sup>th</sup> axis
- Oil skimmer



12 position umbrella tool changer



LED Internal lamp



Chip flushing system



4<sup>th</sup> axis (optional)



Tool probe (optional)



Chip collector & Coolant tank

Worktable

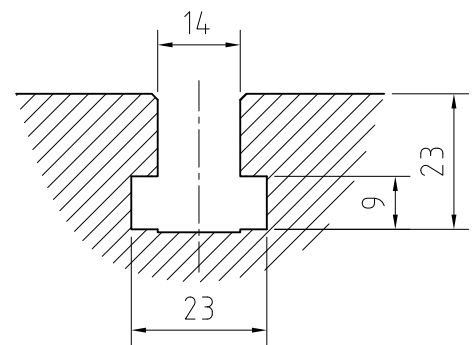
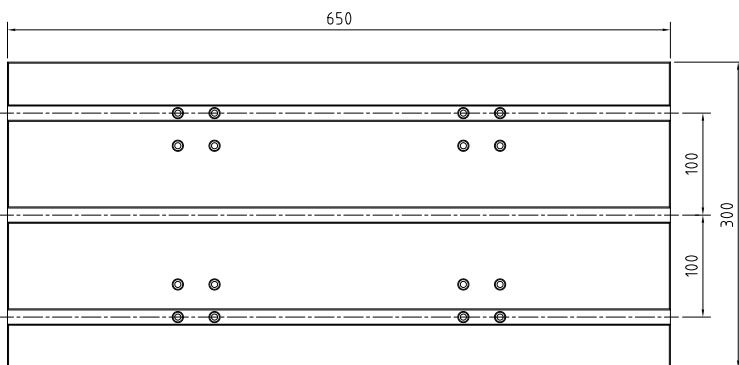

Dimensions

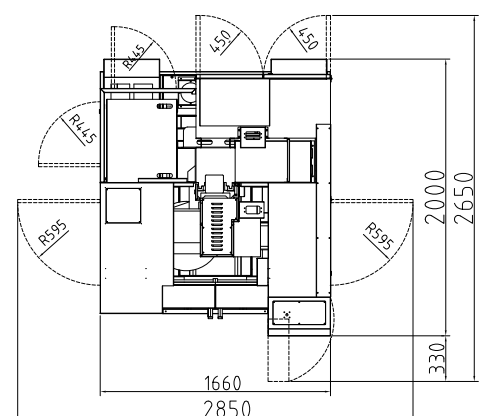
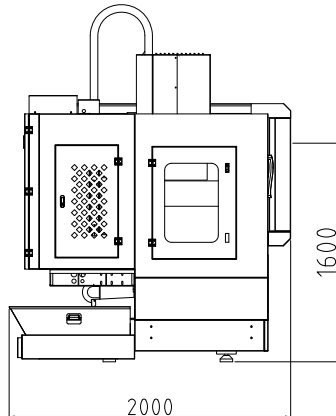
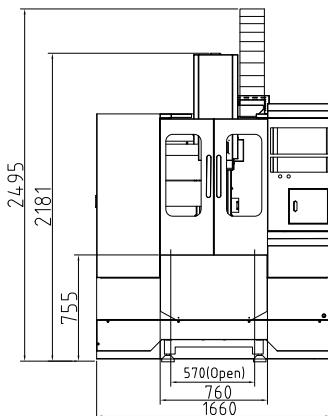

\* The above specifications are subject to change without prior notice, no liability for mistakes. Machines may be shown with optional equipment.